

REF.:5920

Andorra | Sotheby's  
INTERNATIONAL REALTY

# Consolidated Land to buy in the town of Pal

Andorra - Pal

Superficie	Habitaciones	Baños	Precio
<b>444 m<sup>2</sup></b>	<b>0</b>	<b>0</b>	<b>Reservado €</b>

Contáctenos para recibir más información o solicitar una visita

 +376 872 222

 info@sir.ad



REF.:5920

# Consolidated Land to buy in the town of Pal

Andorra - Pal

Superficie	Habitaciones	Baños	Precio
<b>444 m<sup>2</sup></b>	<b>0</b>	<b>0</b>	<b>Reservado €</b>

Contáctenos para recibir más información o solicitar una visita

 +376 872 222

 info@sir.ad

Land located in the village of Pal, La Massana. Covering an area of 444.97m<sup>2</sup>, this consolidated plot is for those looking to create their own personalized space in a natural and peaceful setting. This land has a strategic location, within the old town of Pal, which makes it a promising investment. Its privileged orientation towards the south, and its location within the town, makes it unique to enjoy the tranquility and calm that its surroundings offer. In addition, the proximity to the slopes of Pal de Grandvalira Resorts, and the hiking trails that surround it, makes it perfect for lovers of outdoor activities and life in contact with nature. This land in Pal is a gem to discover, just 7 minutes by car from the center of La Massana, offering the possibility to build your dreams in an idyllic setting. Don't miss the opportunity to purchase this unique property and create a custom home in a truly special location.

## Características

-  Assolellat
-  Vistes ciutat
-  Vistes a la muntanya
-  Zona verda
-  Transport públic aprop



REF.:5920

Andorra | Sotheby's  
INTERNATIONAL REALTY

# Consolidated Land to buy in the town of Pal

Andorra - Pal

Superficie	Habitaciones	Baños	Precio
<b>444 m<sup>2</sup></b>	<b>0</b>	<b>0</b>	<b>Reservado €</b>

Contáctenos para recibir más información o solicitar una visita

 +376 872 222

 info@sir.ad

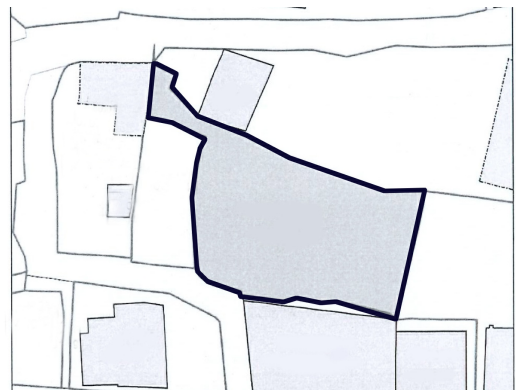

Sotheby's International Realty® is a registered trademark licensed to Sotheby's International Realty Affiliates LLC. Each Sotheby's International Realty® office is independently owned and operated.

Andorra Sotheby's International Realty  
Calle Santa Anna, 14 AD700 Escaldes-Engordany Principado de Andorra  
Tel: +376 872 222 · Email: info@sir.ad

[www.andorra-sothebysrealty.com](http://www.andorra-sothebysrealty.com)